

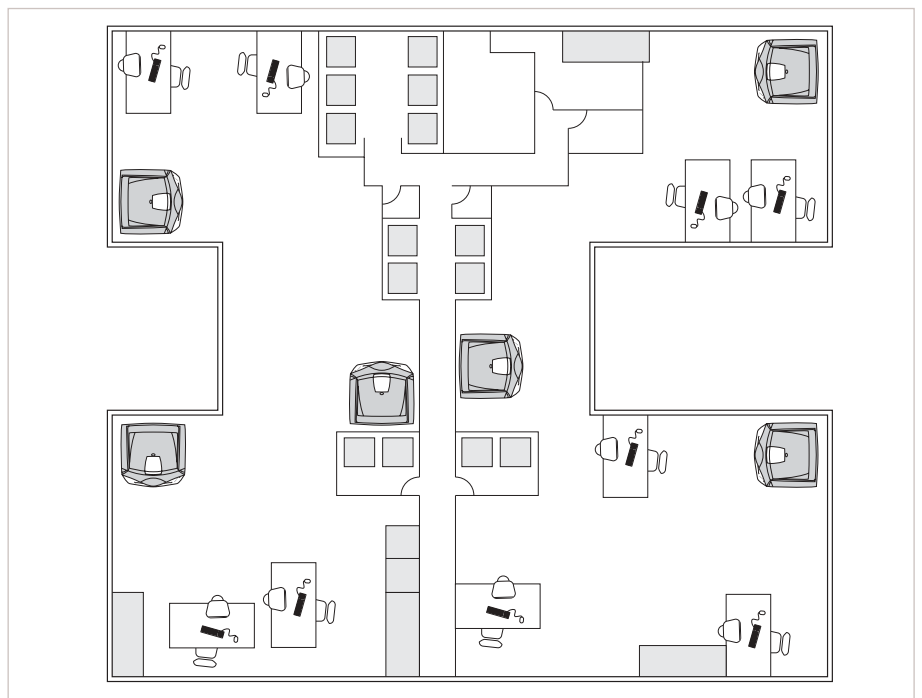

The MarkVision Professional™ print management application increases end-user productivity while reducing IT and Helpdesk cost through easy to use remote problem prevention and resolution.

- **Pro-active Monitoring**
 - Real-time remote operator panel & printer status
 - Real-time filterable notification of printer conditions
 - Perform tasks automatically depending on printer conditions
- **Confidence for your Help Desk**
 - Monitor both Lexmark and 3rd Party multi-function devices and printers
 - Apply enhanced secure communications settings quickly
 - Install and configure multiple devices simultaneously
- **Simple, flexible interface**
 - Customise most important tasks on a single home page
 - Group devices logically by any criteria using dynamic filters
 - Find printers easily and quickly using multiple methods

Powerful remote multi-function device and printer management



MarkVision Professional

Pro-active real-time remote management.

MarkVision Professional is designed to reduce the overall cost of network printing services while increasing the availability and variety of printing resources for all users. With more and more print devices distributed across organisations, the need for a printer and multi-function device management tool has become even more critical. MarkVision Professional makes it easy to set up, manage and maintain your printers and multi-function devices, while increasing productivity across your enterprise.

A solution that satisfies IT and your Helpdesk center

MarkVision Professional gives you the ability to monitor, configure and manipulate networked printer and multi-function devices in your enterprise, including those at different sites, in real time from one central point or through a web browser at any point anywhere in the company.

This will help in preventing and if necessary resolving printing problems quickly and cost effectively.

Go one step further and automate processes!

Inside MarkVision Professional, the MarkVision Messenger listens for certain printer events to occur, then sends an alert automatically when that condition arises. It provides real-time notification of printer conditions via e-mail, paging or other applications. It also facilitates automated response to any alert before it becomes critical and disruptive to user productivity.

Too many printers, too little time?

MarkVision Professional lets you organise your printers into a tree-like structure similar to that of a corporate organisational chart. In this way, you can locate and monitor those devices quickly and easily.

A Home Task Page allows users to create groups of tasks by adding or removing tasks to fit the organisation's needs.

When you have many printers on your network, being able to choose and view only those mission-critical printers or any other priority printer condition you can formulate, is essential. MarkVision Professional can automatically group devices into folders based on real-time status alerts, or filters.

SERVER AND CLIENTS ENVIRONMENTS SUPPORTED

These are true for both installations except where stated:

- Windows 98/Me/XP (client only)
- Windows NT 4.0/2000/XP/ Server 2003
- HP-UX 11.00
- IBM AIX 4.3.3, 5.1, 5.2
- Sun Solaris 2.6, 9
- SuSE Linux 7.1, 7.2, 7.3, 8.0
- RedHat Linux 7.1, 7.2, 7.3, 8.0

FEATURES SUPPORTED

- Customisable user interface
- Plug-in support for new devices and functions to reduce need for re-installing the software
- Remote Printer Monitoring & Management
- Real-time pro-active alerts with filtering
- User Accounts and groups
- Dynamic device folders and filters
- Quick printer find
- Scheduled tasks
- Automatic TCP/IP and IPX discovery
- Management of other manufacturers printers
- Links to multiple web pages
- Runs as an application or in a browser
- Customisable home Task page

LEXMARK CONNECTIVITY SUPPORTED

- MarkNet N Series and X2000 Series print servers
- MarkNet S, XL, XLe, Pro 1 and 3

NETWORK PRINTERS SUPPORTED*

Full bi-directional (NPAP)

- Optra Family of Laser Printers
- Lexmark T, C, W
- Lexmark E323n, E332n
- Lexmark MFP range - X52x, X62x, X63x, X422, X820, X720, X750e, X752e, X912e, X83xe

Using SNMP

- Any common-MIB compliant printer or MFP
- Specific support is provided for:
 - Brother HL-1470N Series
 - Brother HL-1650/1670N Series
 - Brother HL-2460 Series
 - Canon GP 200D
 - Canon Image Class 2100
 - Canon imageRUNNER 330/400, 500, 600, Canon 2800 and 5000i
 - HP 2000, 2500C
 - HP 8550MFP, 8550GM, 2250TN
 - HP Color LaserJet 4550, 8500
 - HP Color LaserJet 2500, 3700, 5500, 4600
 - HP LaserJet 4100 Series and 4100 MFD
 - HP Mopier 320
 - HP Laserjet 4000, 5, 5000, 5M, 5Si, 8100, 2100, 2200, 3300, 4050, 8000, 8150, 9000
 - IBM Infoprint Color 8

- IBM Infoprint 20, 21
- IBM Network Printer 12, 17
- Konica KL-3015
- Kyocera FS-1700/1750, FS-3700+/3750, FS-7000/9000/9000DN- Kyocera FS 1800/3800
- Minolta Color PageWorks, PageWorks 20
- Minolta-QMS Magicolor 2200 and 3100
- NEC SuperScript 1800
- QMS Magicolour 2, 6100
- Ricoh Aficio 450/455, 550, 650, 750, 850, 180, 270, modem 1045
- Ricoh Aficio 350/355
- Ricoh AP3800C Series
- Tektronix Phaser 350, 550, 560, 740E, 780GN, 840DX, 750dx, 750, 850
- Xerox DocuColour 4CP
- Xerox DocuColour 2006
- Xerox Document Centre 220ST, 230ST, 240ST, 440six, 332ST, 340ST, 265ST
- Xerox DocuPrint 4512, C55/C55mp
- Xerox DocuPrint N17, N24, N32, N40, NC60
- Xerox DocuPrint N2025, N2125, N2825, N3225, 4025, N4525DX
- Xerox Phaser 1235, 2135DT, 790, 860, 3400, 5400, 6200, 7700DN and 8200

* visit us at www.lexmark.com to download the latest version of MarkVision Professional or to view a complete list of supported printers



Supported by Lexmark award winning technology, innovative business applications and strong strategic service offerings, Lexmark's highly skilled, specialised account team can assist your organisation to print smarter, move critical information faster and manage your output related costs more efficiently.

This value proposition, Print-Move-Manage, translates into a set of industry-specific solutions and expertise allowing you to improve, maintain and manage your document and printing infrastructure.

PRINT: A full range of advanced printing solutions based on industry leading technology and associated product services that provide leading edge functions at a very competitive cost. These include printers, multifunction devices as well as network and application-specific hardware and software solutions

MOVE: Consulting and implementation services designed to increase productivity while reducing the costs related to your paper-intensive processes through device consolidation, distributed document capture, distributed printing, electronic form integration and paper document workflow automation

MANAGE: A range of services offerings designed for today's business. Starting from the traditional leasing of equipment through per page based billing up to full contract management and outsourcing of your output device fleets. These offers are designed to deliver you the most cost effective solution for output and document management.